



INESING GROUP

Power System Solution

E-HOUSE PRESENTATION





INESING GROUP

Power System Solution



BRIEF PRESENTATION OF THE COMPANY



The Company **INESING** has matured the experience, knowledge and professionalism at the highest level, consolidating its presence in the market for the construction and installation of electrical systems.

Company has dedicated itself to design, supply and start-up complete industrial systems especially oriented to the **generation, transmission** and **distribution** of electric power, is able to deliver projects and products up to any needs.

INESING has structured its organization in order to respond to customers requirement as extremely efficient and reliable partner.

INESING is also a wholesale store of switchgear & transformers, able to guarantee a fast and complete service of installation.

Our headquarter in 6500 sqm (4.000 sqm Built up area and 3.200 sqm offices) give us the possibility to provide a wide and diverse variety of products.

INESING has realized different jobs in Europe, Middle East, Africa, Russia in the last 10 years, earning a leadership role in the field of electric power distribution.

With a new and fast-growing business unit (named "Power System Solution – PSS") INESING is offering consultancies and specialized diagnostic services to Power Plants and T&D Utilities, on transformers, generators, motors, cable and overhead lines. Both in Italy and abroad.

INESING has also another business unit called "Energy System Division" which coordinates projects as a Global EPC Contractor for power plants (renewable and traditional energy) and substations.

The variety of the jobs and the international market in which INESING works allowed INESING to achieve the most important certifications issued by recognized national and international entities.

INESING owns indeed the certificates ISO 9001-2008; ISO 14001 and OHSAS 18001 issued by Lloyd's Register certification body.





E-HOUSE Bringing power to wherever it's needed

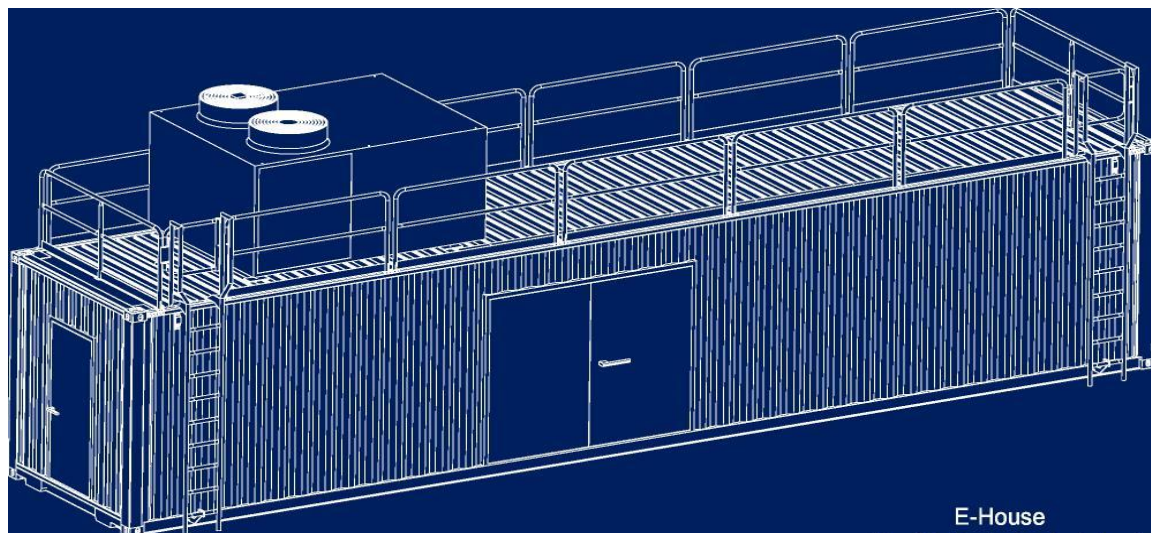

E-House

As an integral part of the Totally Integrated Power concept of INESING, E-House provides electrical power to wherever it's needed – quickly, flexibly and reliably. With E-House, INESING offers customized plug-and-play power supply solutions that cover everything from the planning and engineering to the installation and commissioning. E-Houses reduce construction lead time. They are quickly and easily installed, and the footprint and lead time are optimized thanks to the high quality design.

Ready to use

An EHouse can consist of one or several modules equipped with high quality components, including medium voltage air insulated switchgear (AIS) or gas-insulated switchgear (GIS), low voltage switchboards, power transformers, medium voltage/high voltage (MV/HV) cable drums, protection, monitoring and control systems, Power Management Systems (PMS), Variable Frequency Drives (VFD) as well as AC and DC auxiliary power and building management systems. Completely developed, manufactured, assembled and pretested at the factory or assembly yard prior to delivery, an E-House simply needs to be connected and put into operation onsite.

Numerous applications

Industries, utilities, and infrastructures benefit from our E-Houses, whether it's for power distribution needs or electrical network extensions. They are ideally suited for a broad range of applications as space saving solutions, for example, in areas with difficult access, in harsh environments, as a temporary power distribution solution, or as a mobile power solution for relocation.





A Comprehensive Solution

INESING E-Houses can be fitted with a wide range of power equipment and components from our comprehensive MV and LV portfolio of power solutions. As a pre-fabricated solution, all power supply components are pre-configured before being installed inside and ensure a high degree of functionality and reliability. This very cost-efficient and flexible solution for constant distribution of electrical power guarantees the highest level of personal and system safety.

LV & MV Components:

- Low-voltage distribution board
- low-voltage MCC board
- Gas-insulated medium-voltage switchgear
- Air-insulated Medium voltage switchgear
- AC/DC Converter Units
- MV-LV Power Factor Correction units (PFC)

Energy Automation components:

- SCADA System
- RTU – Remote terminal Unit

HVAC/Ventilation

- HVAC internal/external units up to 80°C
- Natural & Forced Ventilation

DC Components:

- Battery Charger & Batteries
- UPS system
- DC charger & Rectifiers

Transformers:

- Dry Type transformers
- Oil immersed Transformers
- Generator set

Safety System

- Fire Detection System
- Fire suppression system
- CCTV System
- Access control & Anti-intrusion System

Accessories

- Fire dampers
- Sand Traps

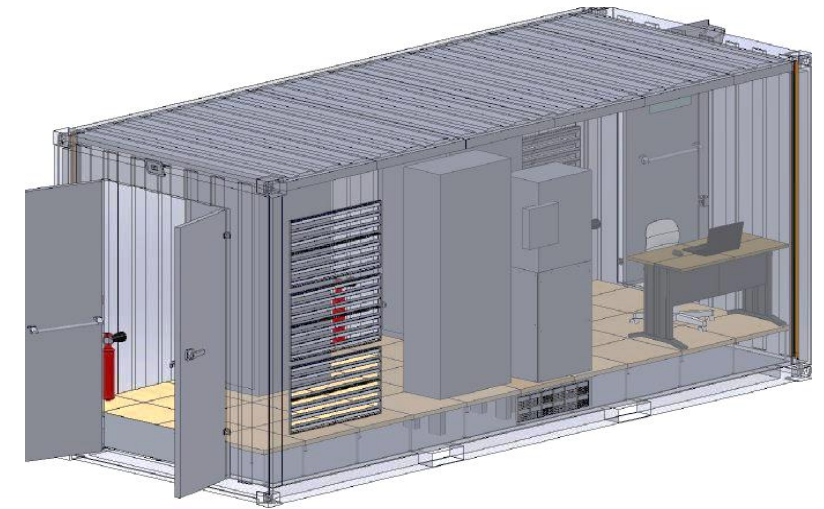



INESING GROUP

Power System Solution



From planning to plug-and play installation

STEP 1 Design

Understanding that every power supply task is unique, we plan and design the E-House to optimally fulfill your needs – quickly and cost-efficiently.

- Overall Electrical Design
- Equipment Layout
- Mechanical Design
- Design of auxiliary equipment and systems (e.g. fire detection, air-conditioning, etc.)



STEP 2 Manufacturing

Following the detailed planning of your E-House, high-quality products and materials are procured, and the E-House is constructed to suit your specific requirements.

- Procurement of high-quality materials
- Manufacturing
- Skilled Labor





INESING GROUP

Power System Solution

STEP 3 Pre-assembly

All elements of the E-House's metal housing, including the steel frame, floor, roof and wall panels are pre-assembled in a controlled factory environment.

- Construction and coating of steel-frame
- Installation of roof, wall and floor elements
- Mechanical installation of equipment

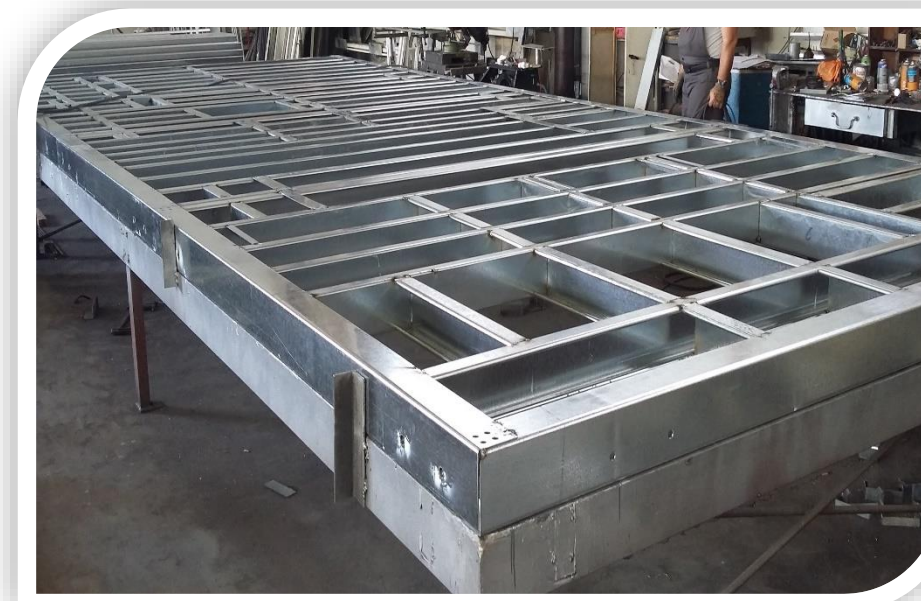

STEP 4 Electrical installation

Whatever the individual power component arrangement of your E-House –our engineering team ensures optimal integration

- Power Equipment
- Auxiliary equipment and systems
- Connection of internal cables





INESING GROUP

Power System Solution

STEP 6 Transport

From planning and calculating load capacities to choosing modes of transport and more - we handle all of the logistics.

- Expertise in heavy and oversized transport
- Safe, fast and efficient transportation
- Logistics management



STEP 5 Pre-commissioning and testing

The high level of quality and functionality of the E-House power equipment and auxiliary systems are assured by fulfilling an extensive inspection and test plan prior to shipping to the project site.

- Pre-testing of all installations
- Pre-commissioning of equipment
- Testing of functionalities



STEP 7 Plug-and-play

After arrival on site, E-House solutions are lifted directly onto their foundations and subsequently installed - the plug-and-play concept minimizes costs, time, and efforts.

- Lifting and mechanical installation of E-House
- Electrical installation of external cables
- Commissioning
- Energization





PARTNERSHIP

COLLABORATION WITH

Chooosed by Schneider as qualified
Supplier for production of Mobile Substation, electrical cabinet & Shelters.





Certificate of Supplier Qualification

Supplier :	INESING SpA	 INESING S.p.A Power System Solution
Supplier code :	10355791	

As conclusion of the process for the Qualification as determined by the procedure Schneider Electric Supplier Approval Module (SAM), we confirm:

the registration

within the List of Suppliers for Solutions systems of Schneider Electric for the following categories of supply of goods/services:

- *Mobile Substation up to 45MVA*
- *Construction of Electrical Cabinets and Shelters*

A poor "Vendor Rating" (delivery times, non-compliances, documentation) or serious offenses charged to Your Company, will cause the suspension or revocation.

The above does not imply any duty or engagement of award for SEE, nor it assigns right to any performance towards the applicant at any title.

Date: 10/05/2017

Matthieu Guilleminou
EMEAS Solutions Purchasing Manager
Regional Execution Center - Energy Business





INESING GROUP

Power System Solution



E-HOUSE FOR MOBILE SUBSTATIONS

OUR LAST BEST REFERENCES

**N. 8 E-HOUSE FOR Mobile Substations 25 MVA 33/11.5 KV
2018
Schneider Electric (FR) for MOE (IRAQ)**



**N. 1 E-HOUSE FOR Mobile Substation 10 MVA 33/11.5 KV
2018-2019
GENERAL PORTS OF IRAQ CO.**





INESING GROUP

Power System Solution



SHELTER AND ELECTRICAL CABINET

REFERENCES

Nr. 3 Shelter for Energy Storage up to 20 MVA
2014-2015
Terna (Italy)

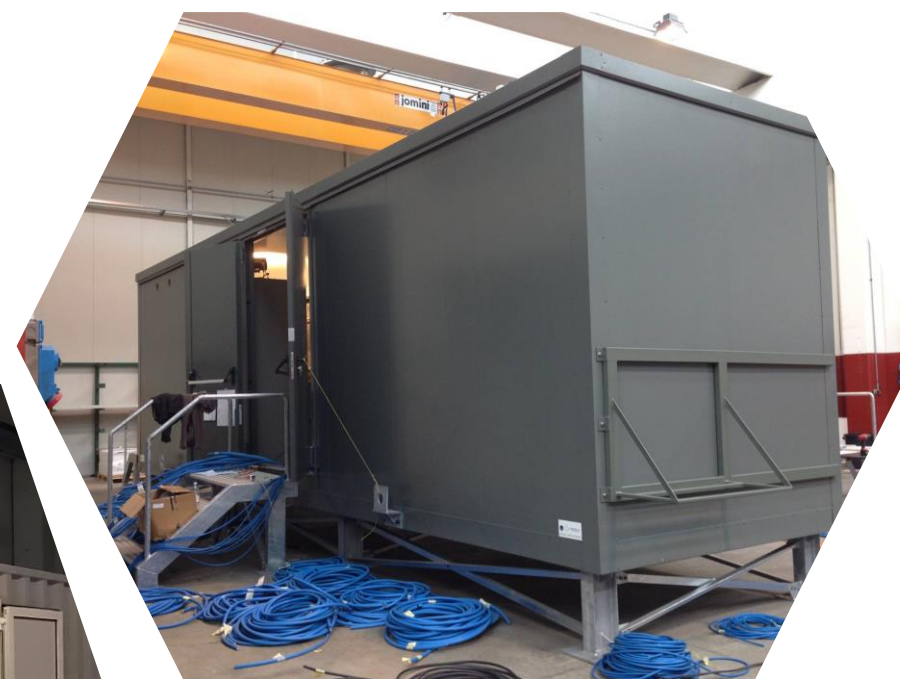

Nr. 5 Shelter 36 kV mini Hydro power plant
2016 - 2017
KOSST SH.A – KOSOVO

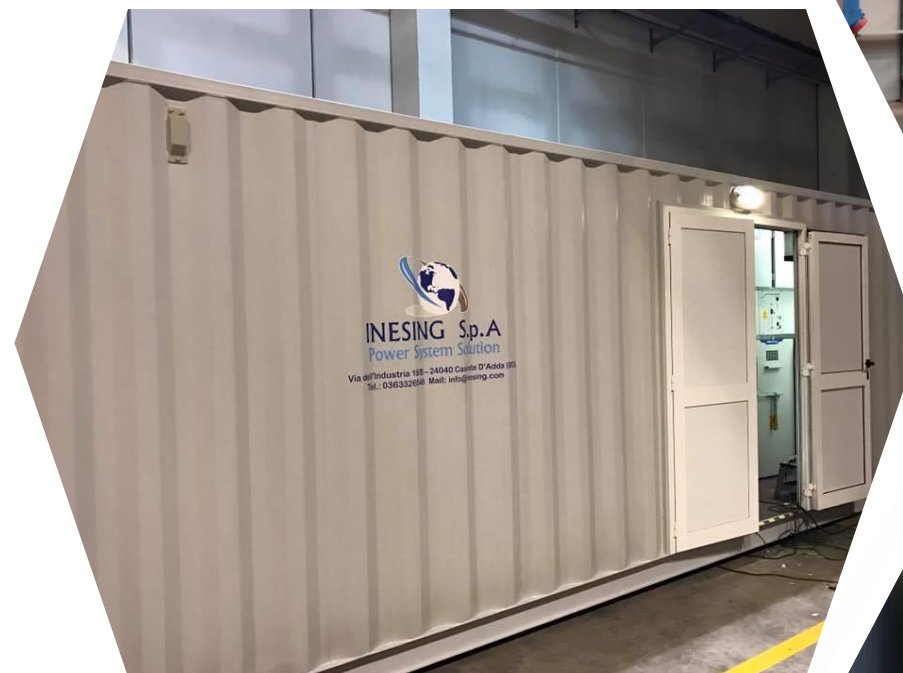

Nr. 1 Power Module for Data Center
2019
Schneider Electric France / ATOS Senegal





ISO CERTIFICATION

- **ISO 9001:2015**
Quality Management System
- **ISO 14001:2015**
Environmental Management System
- **OHSAS 18001:2007**
Occupational Health & Safety Management



Current issue date: 12 September 2019
Expiry date: 29 April 2022
Certificate identity number: 10217289

Original approval(s):
ISO 9001 - 29 April 2013

Certificate of Approval

This is to certify that the Management System of:

INESING Srl

Via Dell' Industria 18/B, 24040 Casirate D' Adda - BG, Italy

has been approved by Lloyd's Register to the following standards:

ISO 9001:2015

Approval number(s): ISO 9001 – 0029062

The scope of this approval is applicable to:

Design, assembly and wholesale marketing of products and systems for the generation, transformation, transmission, distribution and use of electricity in High, Medium, and Low voltage and lighting systems.

Gilles Bessiere

Area Technical Manager

Issued by: Lloyd's Register Quality Assurance Italy Srl

for and on behalf of: Lloyd's Register Quality Assurance Limited



Lloyd's Register Group Limited, its affiliates and subsidiaries, including Lloyd's Register Quality Assurance Limited (LRQA), and their respective officers, employees or agents are, individually and collectively, referred to in this clause as 'Lloyd's Register'. Lloyd's Register assumes no responsibility and shall not be liable to any person for any loss, damage or expense caused by reliance on the information or advice in this document or howsoever provided, unless that person has signed a contract with the relevant Lloyd's Register entity for the provision of this information or advice and in that case any responsibility or liability is exclusively on the terms and conditions set out in that contract.

Issued by: Lloyd's Register Quality Assurance Italy Srl, Via Cadorna, 69 20090 Vimodrone Italy for and on behalf of: Lloyd's Register Quality Assurance Limited, 1 Trinity Park, Bickenhill Lane, Birmingham B37 7ES, United Kingdom

Page 1 of 1



Current issue date: 12 September 2019
Expiry date: 29 October 2021
Certificate identity number: 10217300

Original approval(s):
ISO 14001 - 30 October 2015

Certificate of Approval

This is to certify that the Management System of:

INESING Srl

Via Dell' Industria 18/B, 24040 Casirate D' Adda - BG, Italy

has been approved by Lloyd's Register to the following standards:

ISO 14001:2015

Approval number(s): ISO 14001 – 0028466

The scope of this approval is applicable to:

Design, assembly and wholesale marketing of products and systems for the generation, transformation, transmission, distribution and use of electricity in High, Medium and Low voltage and lighting systems.

Gilles Bessiere

Area Technical Manager

Issued by: Lloyd's Register Quality Assurance Italy Srl

for and on behalf of: Lloyd's Register Quality Assurance Limited



Lloyd's Register Group Limited, its affiliates and subsidiaries, including Lloyd's Register Quality Assurance Limited (LRQA), and their respective officers, employees or agents are, individually and collectively, referred to in this clause as 'Lloyd's Register'. Lloyd's Register assumes no responsibility and shall not be liable to any person for any loss, damage or expense caused by reliance on the information or advice in this document or howsoever provided, unless that person has signed a contract with the relevant Lloyd's Register entity for the provision of this information or advice and in that case any responsibility or liability is exclusively on the terms and conditions set out in that contract.

Issued by: Lloyd's Register Quality Assurance Italy Srl, Via Cadorna, 69 20090 Vimodrone Italy for and on behalf of: Lloyd's Register Quality Assurance Limited, 1 Trinity Park, Bickenhill Lane, Birmingham B37 7ES, United Kingdom

Page 1 of 1



Current issue date: 12 September 2019
Expiry date: 11 March 2021
Certificate identity number: 10217366

Original approval(s):
OHSAS 18001 - 30 October 2015

Certificate of Approval

This is to certify that the Management System of:

INESING Srl

Via Dell' Industria 18/B, 24040 Casirate D' Adda - BG, Italy

has been approved by Lloyd's Register to the following standards:

OHSAS 18001:2007

Approval number(s): OHSAS 18001 – 0028467

The scope of this approval is applicable to:

Design, assembly and wholesale marketing of products and systems for the generation, transformation, transmission, distribution and use of electricity in High, Medium and Low voltage and lighting systems.

Gilles Bessiere

Area Technical Manager

Issued by: Lloyd's Register Quality Assurance Italy Srl

for and on behalf of: Lloyd's Register Quality Assurance Limited



Lloyd's Register Group Limited, its affiliates and subsidiaries, including Lloyd's Register Quality Assurance Limited (LRQA), and their respective officers, employees or agents are, individually and collectively, referred to in this clause as 'Lloyd's Register'. Lloyd's Register assumes no responsibility and shall not be liable to any person for any loss, damage or expense caused by reliance on the information or advice in this document or howsoever provided, unless that person has signed a contract with the relevant Lloyd's Register entity for the provision of this information or advice and in that case any responsibility or liability is exclusively on the terms and conditions set out in that contract.

Issued by: Lloyd's Register Quality Assurance Italy Srl, Via Cadorna, 69 20090 Vimodrone Italy for and on behalf of: Lloyd's Register Quality Assurance Limited, 1 Trinity Park, Bickenhill Lane, Birmingham B37 7ES, United Kingdom

Page 1 of 1



... BRINGS POWER ALL OVER THE WORLD...

INESING FACTORY – ITALY

Via dell'Industria,18/B

24040-Casirate D'Adda (BG)

Tel/Fax: +39 0363 326548

Email: info@inesing.com

INESING INTERNATIONAL – QATAR

Suhaim Bin Hamad St., Al Sadd

P.O.Box 6255 Doha-Qatar

Tel/Fax. +974 444 777 38



INESING GROUP

Power System Solution